

\$467,000 (Not Including Lot) \$92,900 (Lot Price)

17

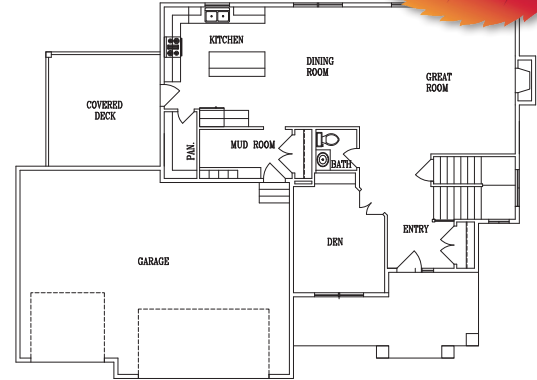

Summit Pointe
6436 Summit Pine Road NW

Finished Square Footage (Not Including Garage)	2661
Total Square Footage (Not Including Garage).....	3945
Garage Square Footage	828
Number of Baths.....	3
Number of Bedrooms	4
Exterior Material	LP/Vinyl/Stone
Other Amenities:	* modern farmhouse

* shiplap & barndoor * 9 ft double shower

* unique metal pipe railing * maintenance-free covered deck

Contractor License #BC384273

Tour our latest “Modern Farmhouse” model home! You’ll want to see cool features like shiplap, barn door, unique tile and stone fireplace, custom stair rail w/ horizontal metal piping! Be wowed by the awe-inspiring 9 ft long tiled master shower! All of the amenities you’ve come to expect from this builder, this one is a real show stopper!

Directions: From Hwy 52 North. Take 65th St NW exit. Go west on 65th St NW for approx. 1 mile; turn left on 50th Ave NW; left into the Summit at Summit Pointe via Ridgeview Dr NW; right onto Summit Pine Rd NW.



H&H Company of Rochester, LLC

27282 650th Street

Kasson, MN 55944 • (507) 951-1722

www.HandHcompany.com

This company has been a member of Rochester Area Builders since 2016.

